

**CARATTERISTICHE:**

Diffusori lineari a feritoie con deflettore rotativo a profilo aerodinamico per grandi portate.

COSTRUZIONE:

Alluminio anodizzato estruso, deflettore in polipropilene nero RAL 9005.

IMPIEGO:

A soffitto, in mandata e ripresa.
Altezza di installazione:
2,6-4,0 m.

FISSAGGIO:

- Mediante viti frontali.
- Con staffa interna mobile.
- Con molle all'interno del plenum.

ACCESSORI:

- Plenum di raccordo in acciaio zincato con isolamento.
- Deflettore RAL 9003

CHARACTERISTICS:

Linear slot diffusers with aifoil section rotating deflector for high airflow.

CONSTRUCTION:

Anodized extruded aluminium, deflector made of RAL 9005 black polypropylene.

UTILIZATION:

For ceiling installation and for air intake and delivery.
Installation height:
2,6-4,0 m.



FIXING:

- By frontal screws.
- By inner mounting mobile bracket.
- By springs inside the plenum.

ACCESSORIES:

- Galvanized steel connecting plenum with insulation.
- Deflector RAL 9003.

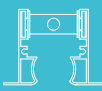
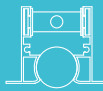
PREZZI - PRICES

| | |  |  |  |  |
|------------------|------------------|---|---|---|---|
| FERITOIE - SLOTS | LUNGHEZZA-LENGTH | DLPCB10 | DLPCB20 | PDLCB | PDLCBI |
| N. | mm* | € | € | € | € |
| 1 | 800 | | | | |
| | 1000 | | | | |
| | 1500 | | | | |
| | 2000 | | | | |
| 2 | 800 | | | | |
| | 1000 | | | | |
| | 1500 | | | | |
| | 2000 | | | | |
| 3 | 800 | | | | |
| | 1000 | | | | |
| | 1500 | | | | |
| | 2000 | | | | |
| 4 | 800 | | | | |
| | 1000 | | | | |
| | 1500 | | | | |
| | 2000 | | | | |

*N.B.: le lunghezze riportate sono da intendere passaggio aria - The lengths are actual neck sizes

VERNICIATURA - PAINTING:

Colori RAL 9010 - 9016: + 15% - Color RAL 9010 - 9016: + 15%

Altri colori: prezzi a richiesta - Different colors: prices on request

MODELLI - MODELS:

DLPCB10: Diffusore standard (1) - Standard diffuser (without sliding control damper and deflector) (1)

DLPCB20: Diffusore con deflettore (1) + (2) - Diffuser with deflector (1) + (2)

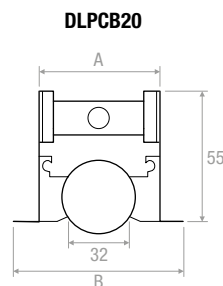
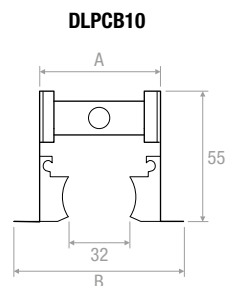
DISEGNI - DRAWINGS

MISURE - MEASURES

| N. feritoie N. slots | Lunghezza mm Length mm | Ø collarino est. N. collarini Ø spigot N. spitos | A mm | B mm | S mm | NR. CM Molle Spring | NR. CVL Cavalletti Mounting brackets |
|-------------------------|---------------------------|---|------|------|------|---------------------------|---|
| 1 | 800 | 98-1 | 51 | 73 | 56 | 2 | 2 |
| | 1000 | 98-1 | | | | 2 | 2 |
| | 1500 | 98-2 | | | | 2 | 2 |
| | 2000 | 98-3 | | | | 3 | 2 |
| 2 | 800 | 148-1 | 102 | 124 | 107 | 4 | 2 |
| | 1000 | 148-2 | | | | 4 | 2 |
| | 1500 | 148-3 | | | | 4 | 2 |
| | 2000 | 148-4 | | | | 6 | 2 |
| 3 | 800 | 198-1 | 153 | 175 | 158 | 4 | 2 |
| | 1000 | 198-2 | | | | 4 | 2 |
| | 1500 | 198-3 | | | | 6 | 2 |
| | 2000 | 198-4 | | | | 6 | 3 |
| 4 | 800 | 198-2 | 204 | 226 | 209 | 4 | 2 |
| | 1000 | 198-2 | | | | 4 | 2 |
| | 1500 | 198-3 | | | | 6 | 2 |
| | 2000 | 198-4 | | | | 6 | 3 |

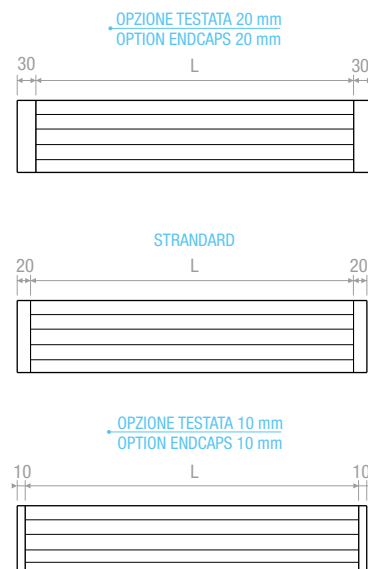

DISEGNI - DRAWINGS

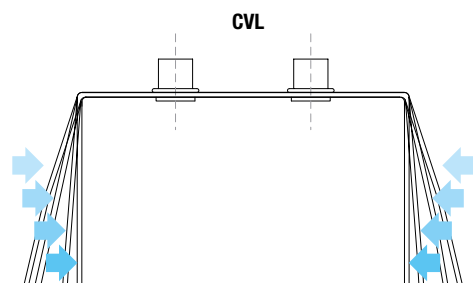
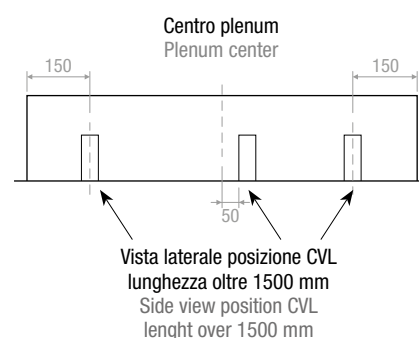
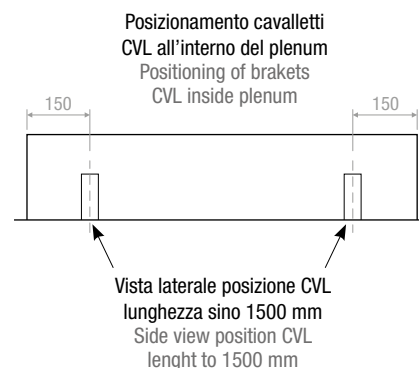
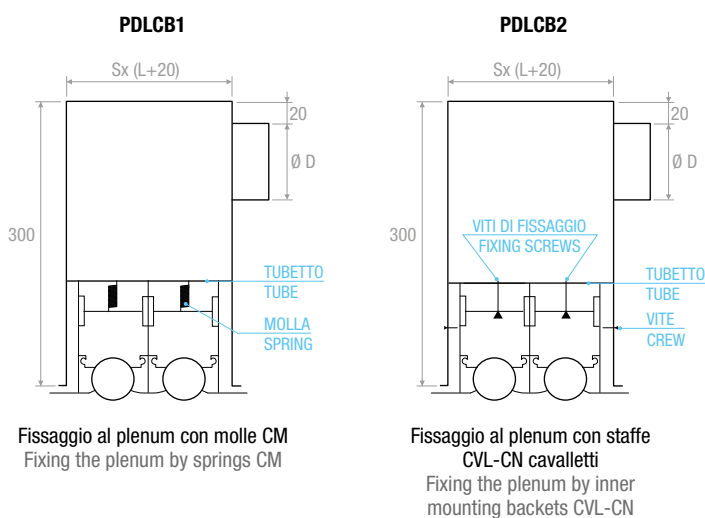

Modifica configurazione CVL da PDL3 a PDL2 con pressione delle dita
Configuration change CVL to PDL3 to PDL2 with finger pressure

SOLUZIONE DI CONTINUITÀ - CONTINUITY SOLUTION

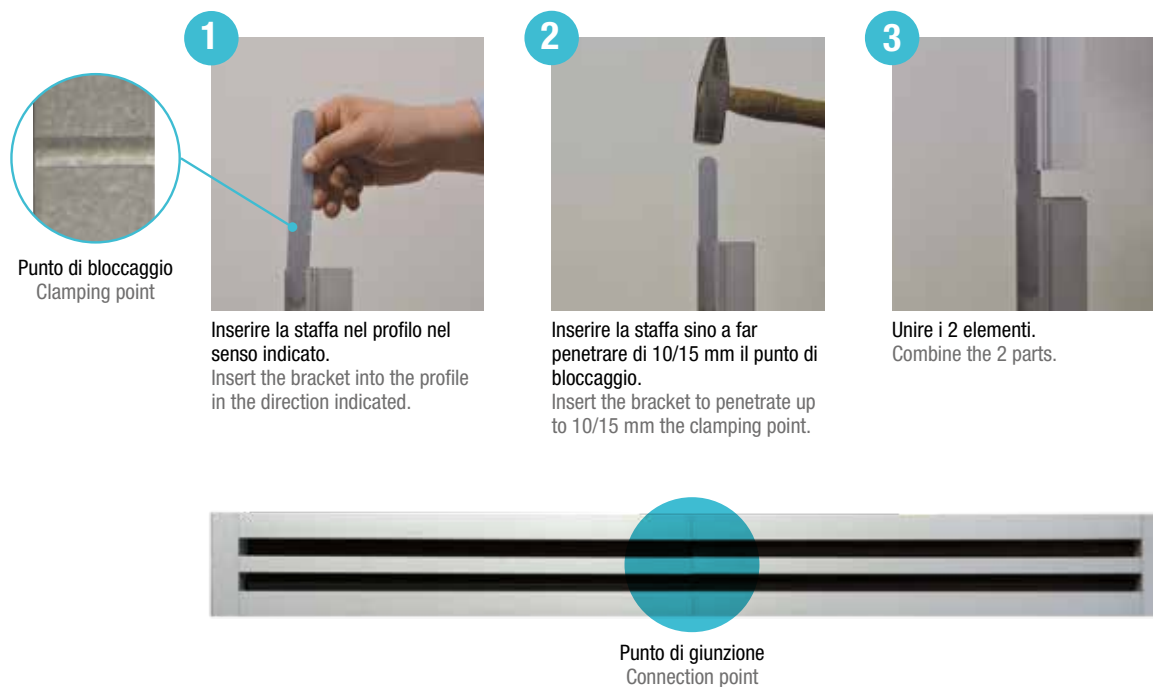

ACCESSORI - ACCESSORIES

| | | € |
|--|--|---|
| CVLCB 1-4 Feritoie - 1-4 Slots | | |
| CM Molla - Spring | | |
| CG Gancio - Hook | | |
| CCCN Kit Continuità (2 pezzi) Kit continuity (2 pieces) | | |

TABELLA DI SELEZIONE - SELECTION TABLE

| Modello - Model | A_k [m²] | Q [m³/h] | | L_{WA} [dB(A)] | | $X_{(0,25)}$ [m] | | Dp_t^* [Pa] | |
|--------------------|------------|----------|-----|------------------|-----|------------------|------|---------------|-----|
| | | min | max | min | max | min | max | min | max |
| DLPCB1 1000 | 0,013 | 80 | 220 | - | 43 | 3,0 | 7,4 | 10 | 50 |
| DLPCB2 1000 | 0,026 | 190 | 420 | 24 | 45 | 4,1 | 9,1 | 10 | 50 |
| DLPCB3 1000 | 0,039 | 270 | 600 | 25 | 47 | 4,4 | 10,1 | 10 | 50 |
| DLPCB4 1000 | 0,052 | 340 | 760 | 25 | 47 | 4,8 | 10,7 | 10 | 50 |

*Senza equalizzatore e serranda completamente aperta - Without equalizer and calibration damper completely open